

# **PROPOSED COUNTY ASSEMBLY OF SAMBURU CHAMBERS FINISHES**

In this proposal, it was assumed that the number of MCAs is 50, 50 seats for VIP gallery and 50 seats for Public gallery.

The floor of the chambers was assumed to have screeding and therefore, hacking/ Racking were going to be made to accommodate the MCAs seat platform, VIP gallery Platform, Public gallery platform.

The layout for the MCAs Seats was taken to be in elliptical shape and/or takes the shape of the chambers floor plan.

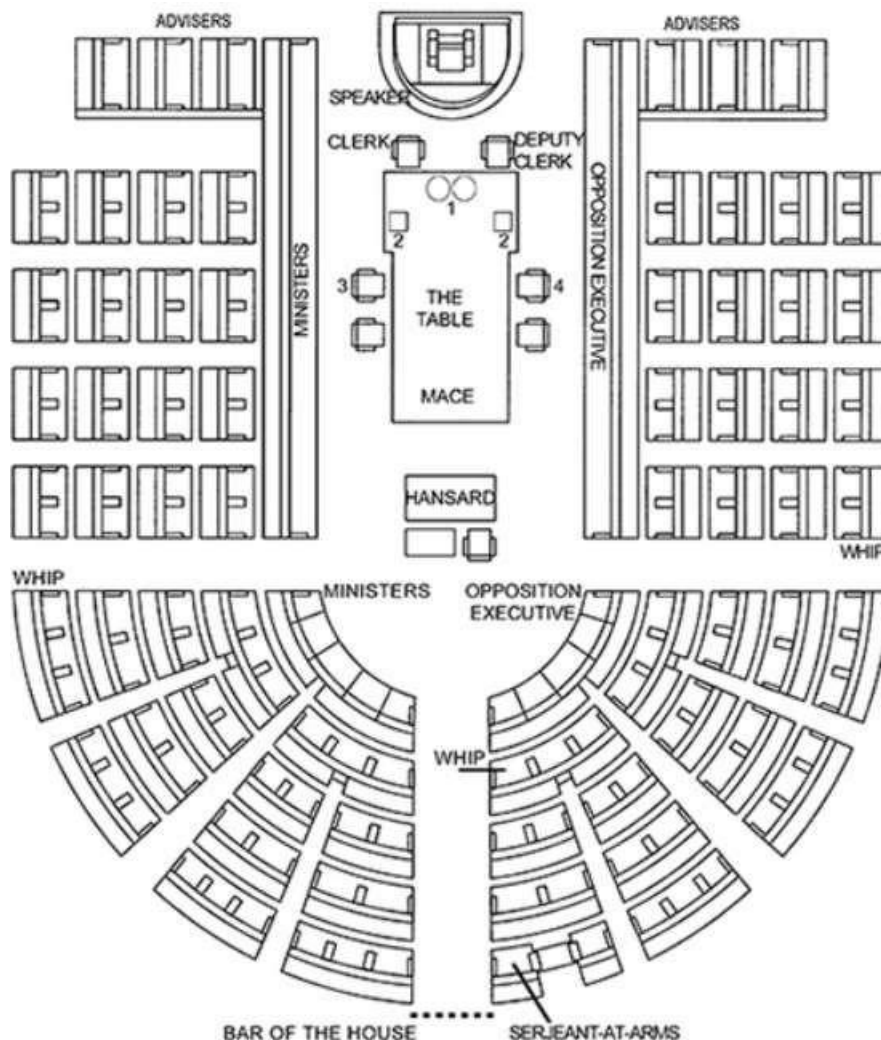

Proposed Layout but may change with client's preference and space

The Hansard box is going to be placed on a mezzanine floor or casted concrete floor on one of the voids in the county assembly floor plan. The region Marked X.

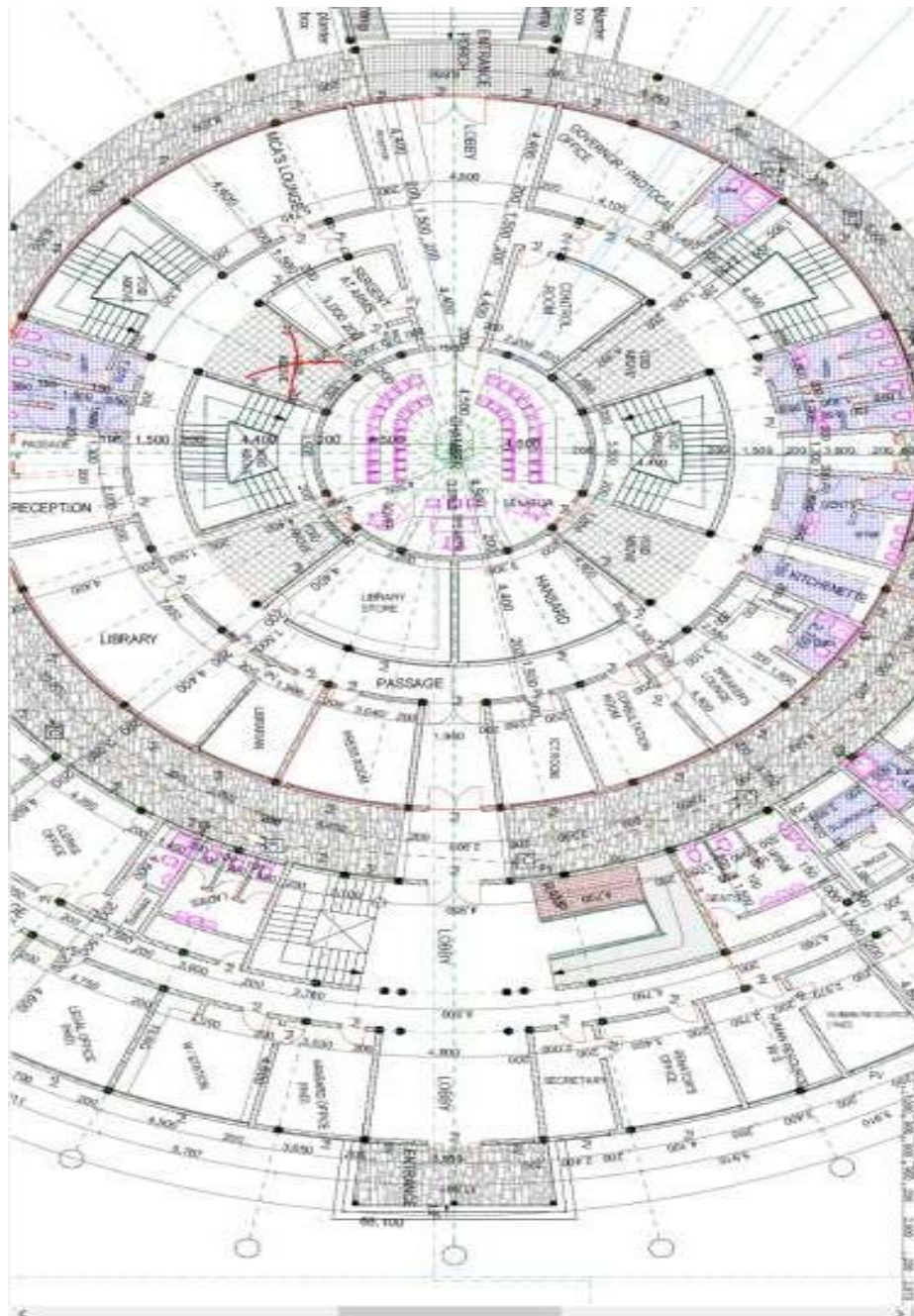

**Walls**

The wall sound proofing and Art work is taken to be as described in the bill of quantities, Colours proposed are as shown but not limited to picture shown below;



Wall sound Proofing and Artwork

## **Speaker's Gallery Decoration**

The proposed Speakers gallery is to be made of Mahogany hardwood, including frames, with the stiles artistically done as shown but not limited to the picture below,





**Floor Carpet**

The floor carpet is proposed to be red in colour with characteristics and features matching the description in the attached bill of quantities. This is not limited to the picture shown below;



**Speaker's table/ Speakers Platform, Maze Table, Clerk's Workstation and Dispatch table (approx. 20SM floor area)**

The diamond shaped wood art can be painted to client's preference



**MCAs work Station and Chairs**











## **Public and VIP Gallery, Speaker's Table,**

Glass as describe in the attached bill of quantities is to be placed as Balustrades or Railing in the section illustrated in the picture below



Single Leaf Doors

VIP Gallery

Speaker's Table

Samburu County Assembly





**Clerk's Table Carpentry work**



## Ceiling Finish

The ceiling is to be acoustic ceiling with necessary accessories. It is going to be made of sound proof panels and to be as described in the bill of quantities attached thereof. The ceiling is going to follow the roof profile of the second floor and as per the second floor plan. Consider the Section view shown below;

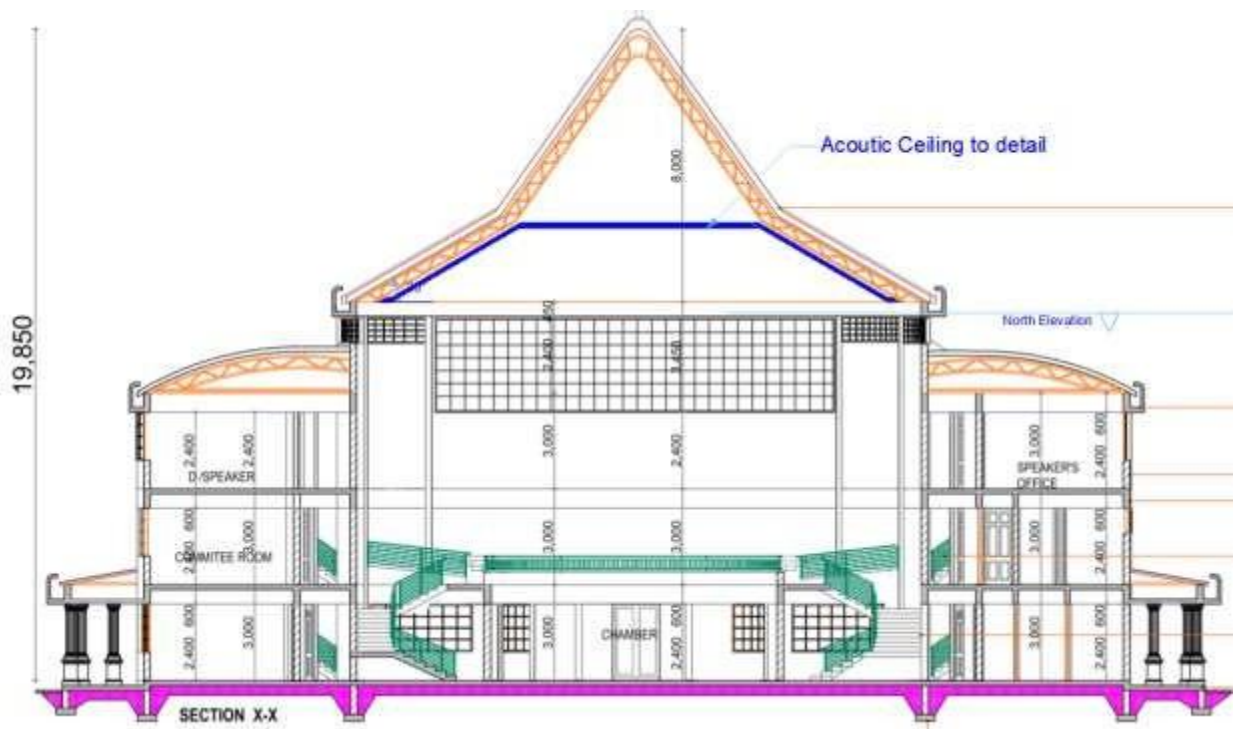



Acoustic Ceiling With sound Proofing Panels

**MCA's Chairs and Work Station Layout**



**Public Television and CCTV**



**Provision for Artwork On Walls (Cultural Pictures)**





**Public & VIP Gallery Glass Railing**





**Speaker's Office/ Clerk's Office (Optional)**



**DESIGN PICTORIALS**







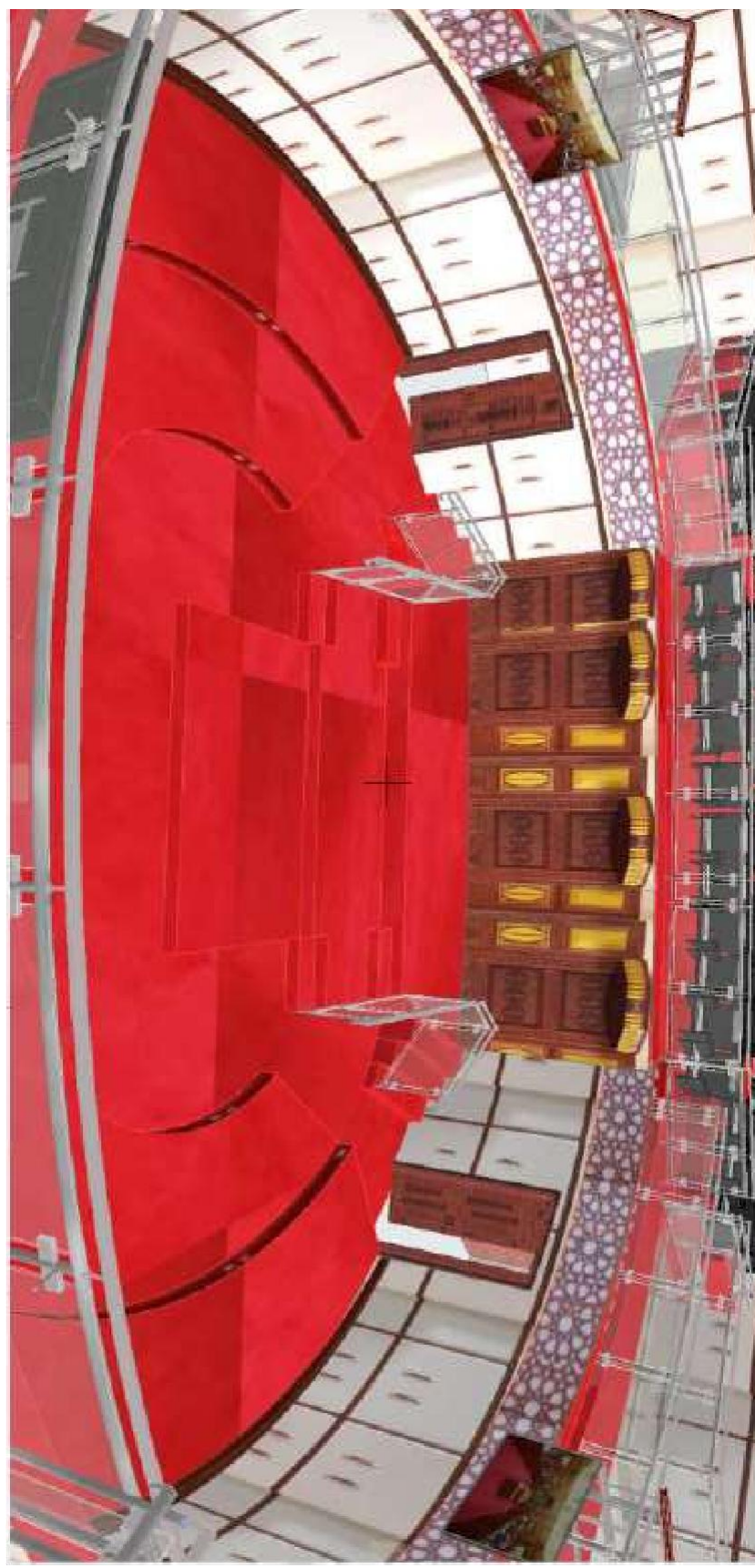



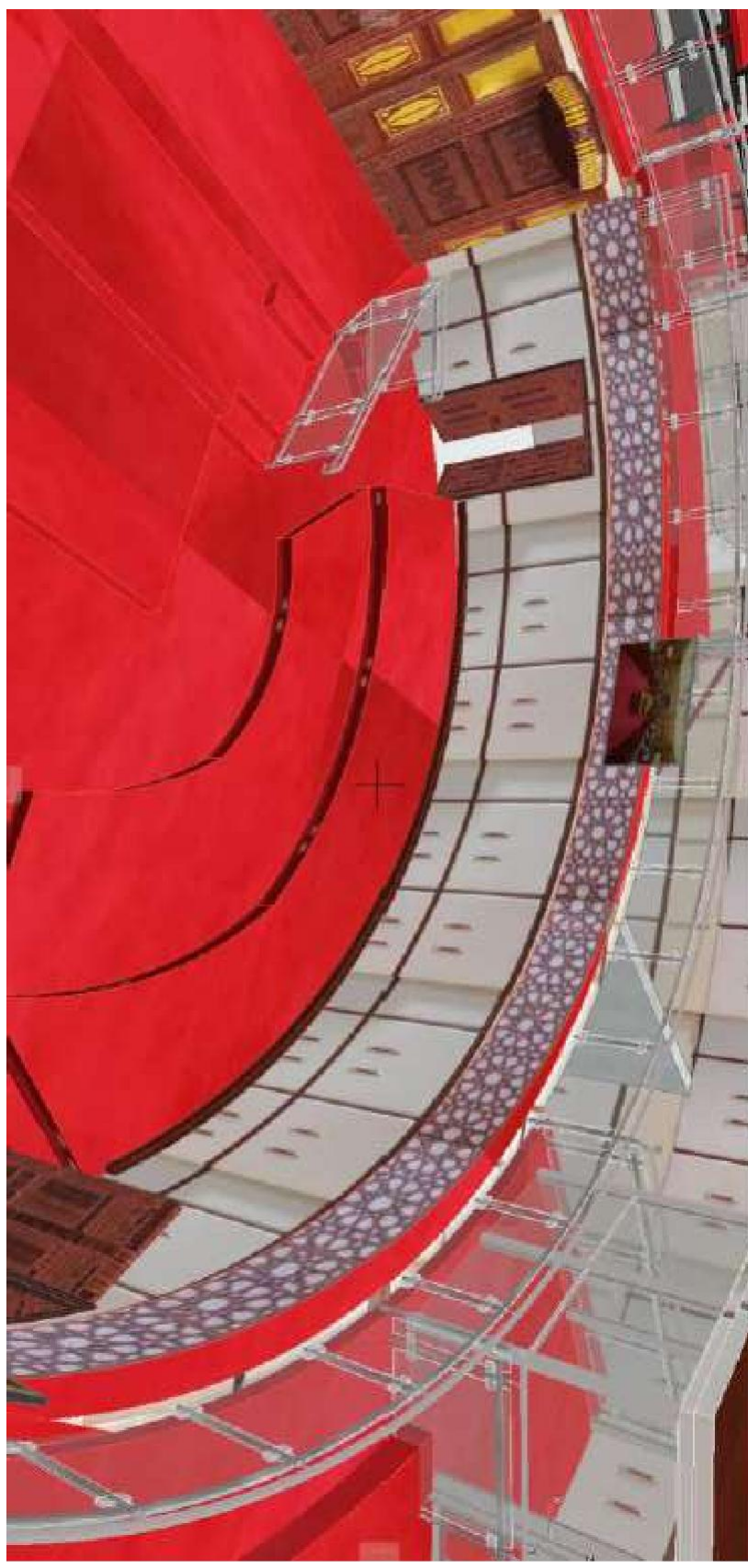



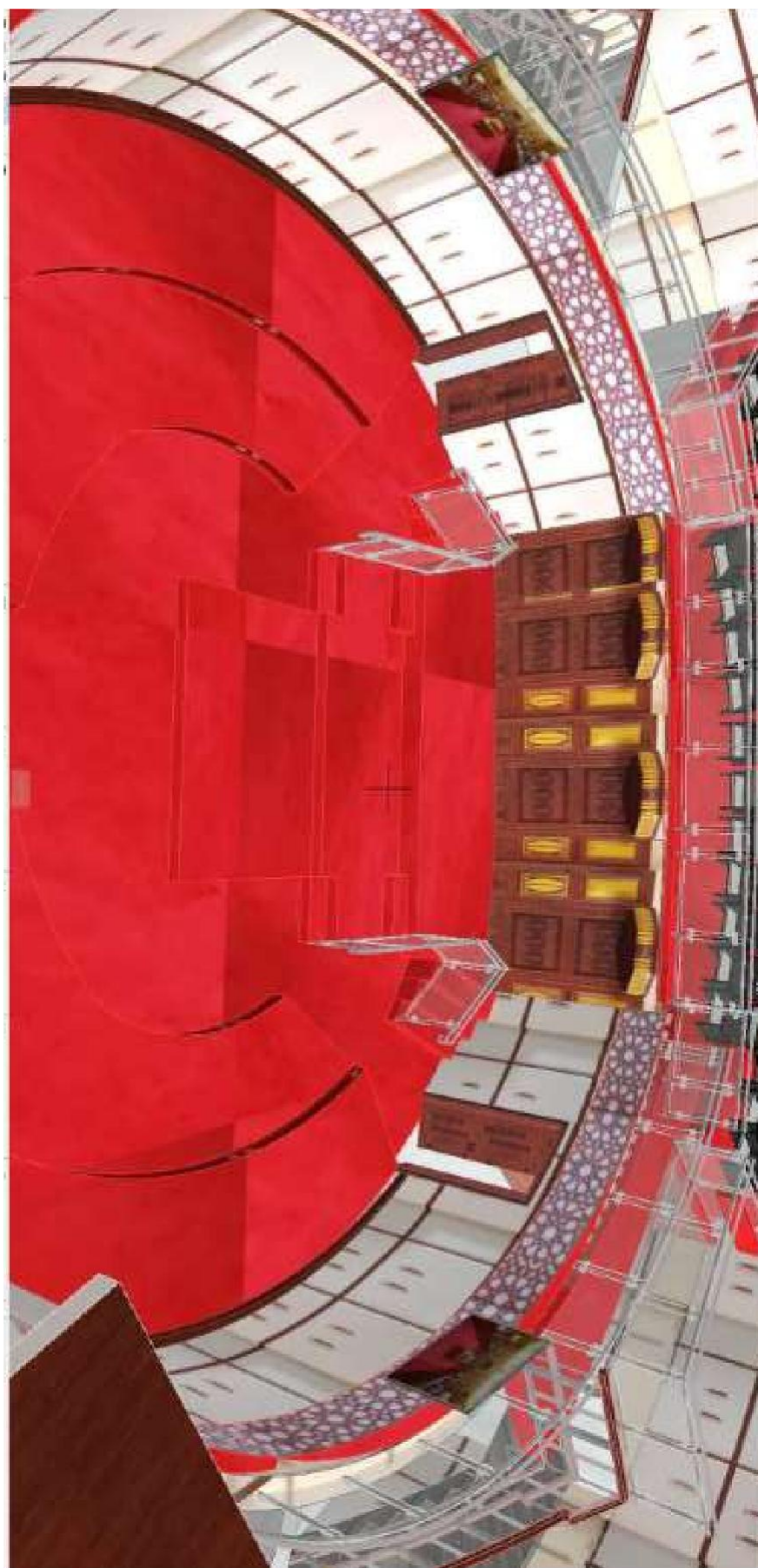

Samburu County Assembly



